

## TEAT POCKETS

TEAT mounting depth*	L <sub>1</sub> (mm)	L <sub>2</sub> (mm)
50	75	50
80	105	80
100	125	100
150	175	150
200	225	200
250	275	250
300	325	300
350	375	350
450	475	450

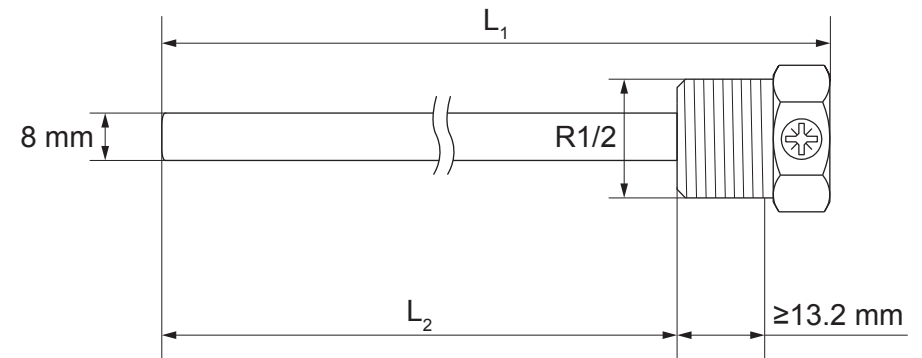
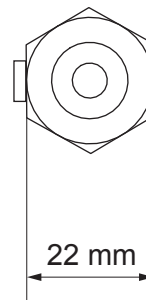

\* TEAT PT 1000 -> mounting depth = 80 mm  
TEAT PT 1000-300 -> mounting depth = 300 mm

Pocket materials:

- stainless steel (AT)
- brass (ATM)
- acid proof steel (ATH)